

# Pipeline Dynamics

**V3FSFB**

**V3FSRB**

**3-PIECE BALL VALVES 2000 PSI  
FIRE SAFE TO API 607**



## FEATURES:

- \* PIPE THREAD IN ACCORDANCE WITH:  
NPT, BSPT, DIN 259 / 2999, ISO 228 CLASS A
- \* FULL PORT OR STANDARD PORT
- \* SCREWED / SOCKET / BUTT WELD ENDS
- \* PRESSURE RATING: 2,000 PSI (138 BAR) W.O.G
- \* WITH ISO 5211 MOUNTING PAD
- \* SIZE: 1/4"~ 2"
- \* MATERIAL: CF8M / CF8 / WCB

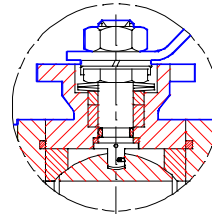

Enlarged View  
for Belleville  
Spring Washer  
Stem Packing

ANTI-STATIC DEVICE  
FULL PORT 1/4"-1/2"  
STANDARD PORT 1/4"-3/4"

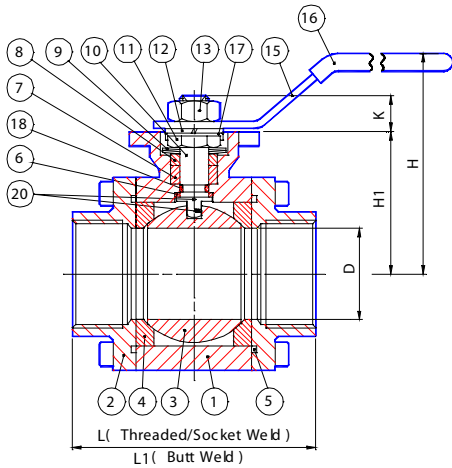
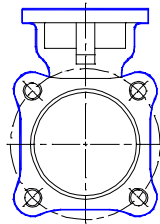
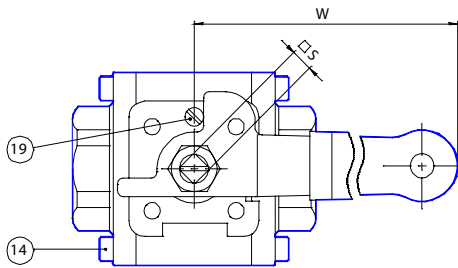
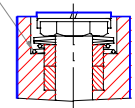

FULL PORT 1/4"-1 1/2"  
STANDARD PORT 1/2"-2"

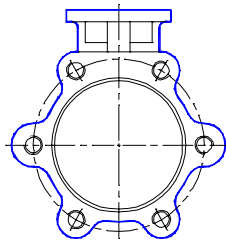

FULL PORT 2"

### \* MATERIALS LIST \*

NO.	DESCRIPTION	MATERIAL	
1	BODY	ASTM A351-CF8M	ASTM A216-WCB
2	END CAP	ASTM A351-CF8M	ASTM A216-WCB
3	BALL	ASTM A351-CF8M 316	ASTM A351-CF8M 304 or 316
4	SEAT	PTFE	PTFE
5	GASKET	GRAPHITE	GRAPHITE
6	THRUST WASHER	GRAPHITE	GRAPHITE
7	STEM PACKING	GRAPHITE	GRAPHITE
8	GLAND	AISI 304	AISI 304
9	BELLEVILLE WASHER	AISI 301	AISI 301
10	STEM	ASTM A276-316	ASTM A276-304 or 316
11	PACKING NUT	AISI 304	AISI 304
12	HANDLE WASHER	AISI 304	AISI 304
13	HANDLE NUT	AISI 304	AISI 304
14	BOLT	AISI 304/ GR B8	AISI 1045
15	HANDLE	AISI 304	ZINC PLATED STEEL
16	HANDLE COVER	PVC	PVC
17	LOCK SADDLE	AISI 304	AISI 304
18	O-RING	VITON	VITON
19	STOP BOLT	AISI 304	AISI 1045
20	ANSI-STATIC DEVICE	AISI 304	AISI 304

### \* DIMENSION LIST:

UNI 1:MM

SIZE	ØD(F)	ØD(S)	ØE	ØF	H	H1	■S	K	L	L1	W	X	ISO 5211	
DN 08	1/4"	11.0	11.0	14.2	13.8	70	37.5	9	8.0	65	70	140	10	F04
DN 10	3/8"	11.0	11.0	17.6	17.3	70	37.5	9	8.0	65	70	140	10	F04
DN15	1/2"	14.0	11.0	21.8	21.7	70	37.5	9	8.0	75	75	140	13	F04
DN 20	3/4"	20.5	14.0	27.2	27.2	90	52	11	11.0	80	90	180	15	F04-F05
DN 25	1"	25.0	20.5	33.9	34.0	100	60	11	11.0	90	100	180	15	F04-F05
DN 32	1-1/4"	31.5	25.0	42.7	42.7	112	72	14	17.0	110	110	215	15	F07
DN 40	1-1/2"	37.0	31.5	48.8	48.6	115	76	14	17.0	120	125	215	16	F07
DN 50	2"	50.0	37.0	61.2	60.5	133	93	14	17.0	140	150	215	17	F07

\* Remarks: ØD(F) for Full Port Valves ; ØD(S) for Standard Port Valves.

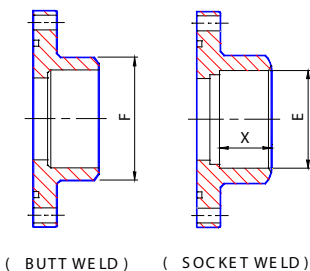

( BUTT WELD ) ( SOCKET WELD )